

MIDDLETOWN-HARGDENBURGH
FIRE DIST.

PUMPER

TID NO. 13606



BODY

- Bolted Stainless Steel Body
- ROM Painted Roll Up Doors
- Rear Slide-In Through Tank Ladder and Pike Pole Storage
- Rear Slide-In Through Tank Hard Suction Storage
- Storage for 12 SCBA Bottles in Wheel Wells
- Toyne Custom Under Step Storage
- Rear Mounted Ladder for Easy Hosebed Access
- Upper Body Coffin Compartments
- Swing-Out Toolboards
- Roll-Out Storage Trays

CHASSIS

- Freightliner M2 112 2-Door Chassis
- Cummins ISL9 450 HP Engine
- 3000 EVS Transmission
- Back-Up Camera
- FireCom Intercom System

TANK

- 1000 Gallon UPF Tank
- ICI SL Plus Tank Gauge
- Rear 4" Direct Tank Fill

PUMP

- Waterous CSU 1500 GPM Pump
- Fire Research Pump Boss Pressure Governor
- Foam Pro 1600 Class A Foam System with 10 Gal. Tank
- Left side: (2) 2.5" Discharges
2.5" Intake
Master Intake
- Right side: 2.5" Discharge
4" Discharge
Master Intake
- (2) 1.75" Crosslays
- Rear 2.5" Discharge
- Piped for Monitor

ELECTRICAL

- FireTech Hi Viz 46" LED Brow Light
- Whelen Warning Lighting
- Fire Research SPA540-Q28 Telescoping Lights
- Kussmaul 2000 Watt Inverter
- Whelen LED Arrowstick
- Akron Revel Scene Lights
- ILLI LED Strip Compartment Lighting

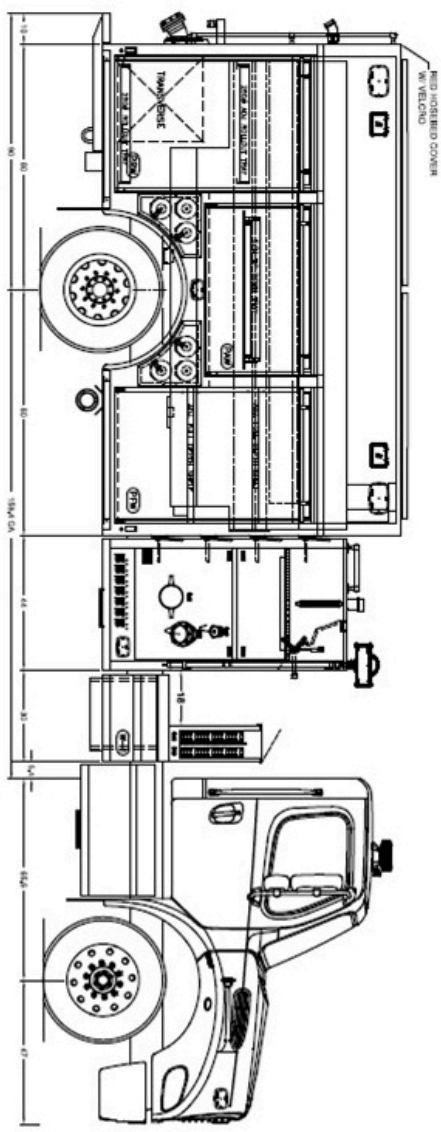
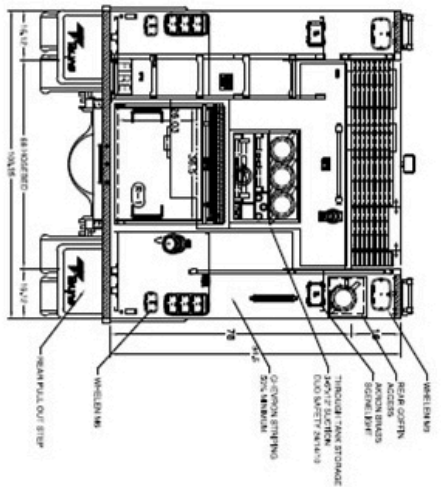

COMP.	HEIGHT	WIDTH	USABLE DEPTH		GUIDE HEIGHT	FT.
			UPPER	LOWER		
DPW	67.12	47.88	1.4	2.6	3.7	35.35
DAW	37.12	63.75	1.4	2.6	2.7	19.18
DRW	67.12	44.00	1.4	2.6	3.7	32.48
PFW	37.12	47.88	1.4	2.6	3.7	35.35
PAW	67.12	63.75	1.4	2.6	2.7	19.18
PRW	67.12	44.00	1.4	2.6	3.7	32.48
R-1	34.12	44.00	1.30	2.6	2.9	23.97
HOSSEBED	1.6	68	---	---	1.32	---
FRONT AXLE	28.75	4.82	---	---	7.375	3.08
REAR AXLE	23.75	4.82	---	---	7.375	3.08

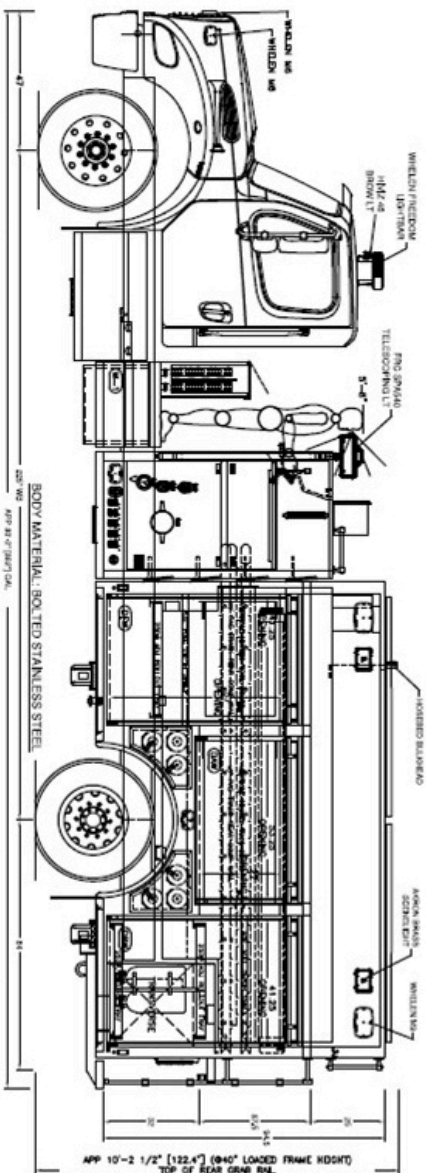
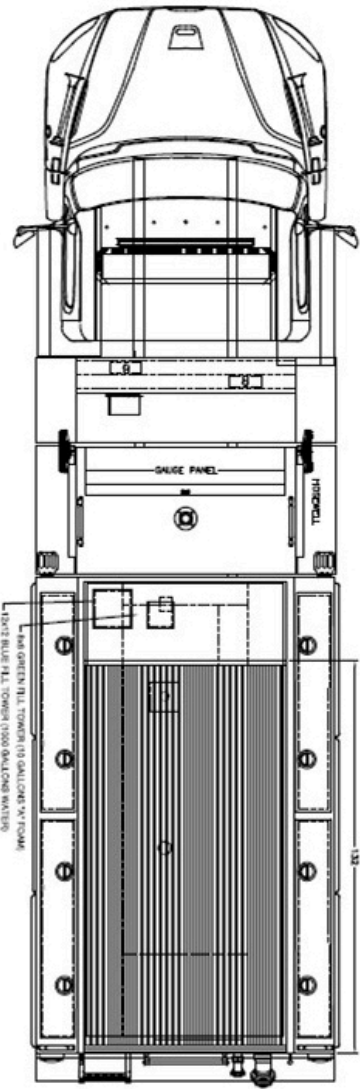

APP 10'-2 1/2" [122.4"] (940" LOADED FRAME HEIGHT)
 TOP OF REAR GRAB RAIL
 EMPTY HEIGHT APP 3'-4" MEASUR EXPANDING UPON AXLE LOADING

NOTE:
 DIMENSIONS SHOWN ARE APPROXIMATE AND ARE SUBJECT TO MINOR CHANGE AS MAY BE FOUND NECESSARY DURING CONSTRUCTION. MINOR DETAILS MAY NOT BE SHOWN. IF DISCREPANCIES EXIST BETWEEN THIS DRAWING AND THE WRITTEN SPECIFICATIONS PROVIDED BY TOYNE, THE WRITTEN SPECIFICATIONS SHALL PREVAIL.

ORIGINAL DRAWING: 30MA-R22	CHASSIS: FREIGHTLINER M2 112 2 DOOR 4x2	SCALE: 1:66	SHEET: A
REV A	31MAR22 WB-CA-F 225'-159.4'-17' D17	CITY: -	
REV B	29JUN22 BODY MTL: BOLTED STAINLESS STEEL	STATE: -	
ISR	29JUN22 PUMP: WATEROUS CSU 1500	DUR: VNS	
CO 1	09MAR23 TANK: 1000'10 UPF POLY-TANK III	CAD: GROSSMAN	
AS BUILT BEB	1NOV23 FOAM SYSTEM: FOAM PRO 1600 7A	DATE: 30 MARCH 2022	
	GENERATOR: N/A	FILE: MARGERTVILLE22	

MARGERTVILLE
 CUSTOM PUMPER

Toyne
 Add to Make the Call

BREDA, IA 51436
 800-648-3358
 WWW.TOYNE.COM